



High Performance

ES2

Easy Servo

Leadshine Technology Co., Ltd. (Headquarters)

Address: Floor 11, Block A3, iPark, 1001 Xueyuan Blvd., Nanshan District, Shenzhen, China

Tel: 86-755-2641-7674 (for Asia, Australia, Africa region)

86-755-2640-9254 (for Europe region)

86-755-2641-7684 (for America region)

Fax: 86-755-2640-2718

Website: www.leadshine.com

Email: sales@leadshine.com



※NOTE: Product appearance and technical parameters are subject to change without notice

Customer Challenges

Annoying with No Best Combination

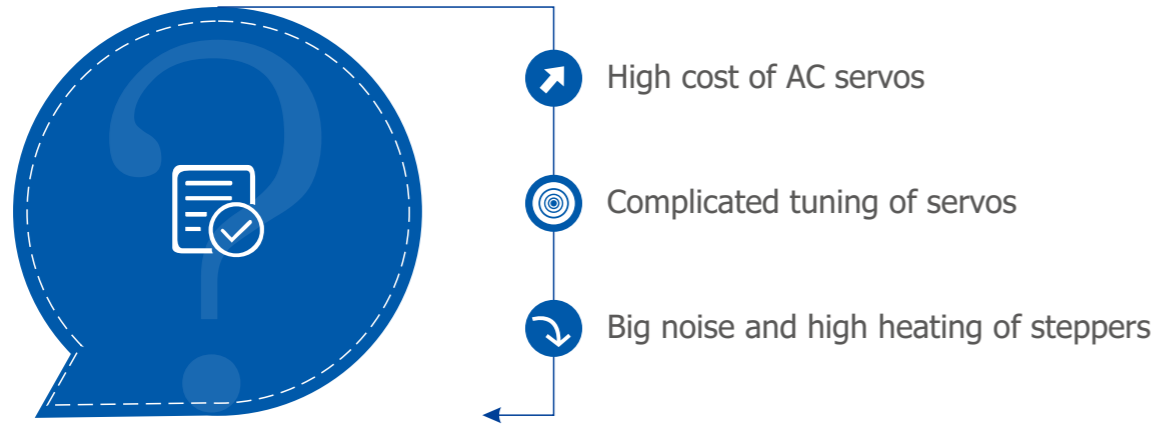

ES2 Easy Servos to Fulfill Your Expectations

The ES2 series easy servos cleverly combined the advantages of AC servo and stepper motor, while it remains high cost-effective. It adopts the advanced vector control technology, using the internal encoder to close the position, velocity and current loops in real time. It guarantees close to and even better performance than AC servos in applications with less than 2500RPM speed at much lower prices, which can help to enhance the competitiveness of your equipment.

Leadshine ES2 Easy Servo=(Enhanced Reliability+AC Servo Performance+High Cost-effectiveness)

Customer Benefits



Advantages to Support A Wise Choice

- Continuous Innovation: Comprehensive Servo Control Algorithms Implementation, Operation Panel for Easy Use
- Well-known Brand with Leading Shipment
- Strict Quality Control and Assurance System: 12 years ISO systems management, 6 years continuous improvement of ES2 series
- Over 10K+ sets of ES2 series stepper system have been used by 1k+ customers globally

ES2 Series Products Overview

ES2-D508	ES2-DA808	ES2-DA1208	ES2-3DA2306
NEMA23, NEMA24 Motor	NEMA34 motor	NEMA34 motor	NEMA34, NEMA42 motor
50VDC, 8A	70VAC, 8A	110VAC, 8A	220VAC, 6A

Contents

1. ES2 Series Easy Servo System
2. The Introduction of ES2 Series Easy Servo Drive
3. The Introduction of ES2 Series Easy Servo Motor
4. ES2 Series Accessories
5. ES2 Series Order Information

01 ES2 Series Easy Servo Systems

- Features
- Typical Applications
- Typical System Configurations
- Matched Drives and Motors



2 Advanced vector control technology for quicker response

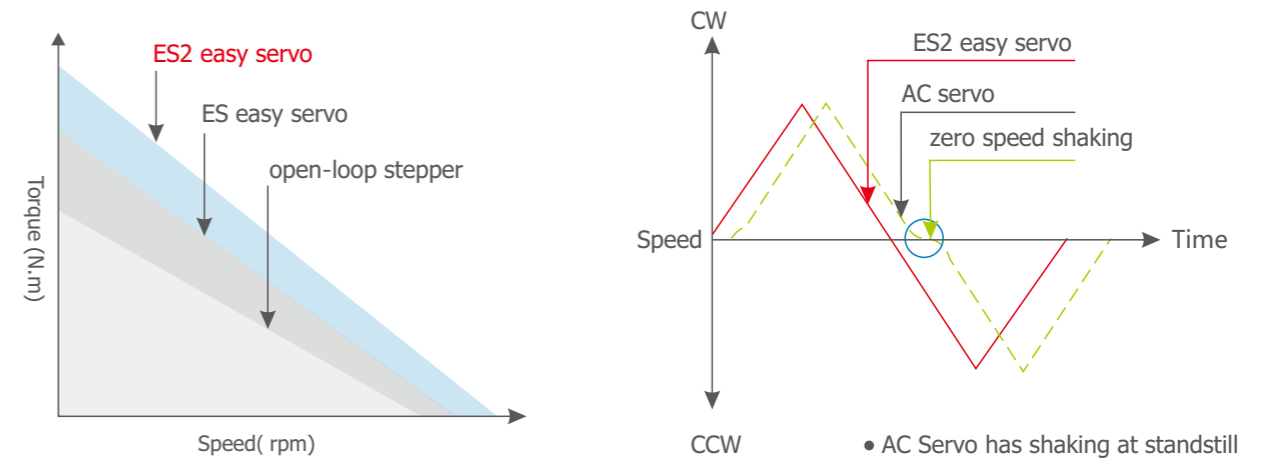

3 Extra low motor heating for reducing energy consumption

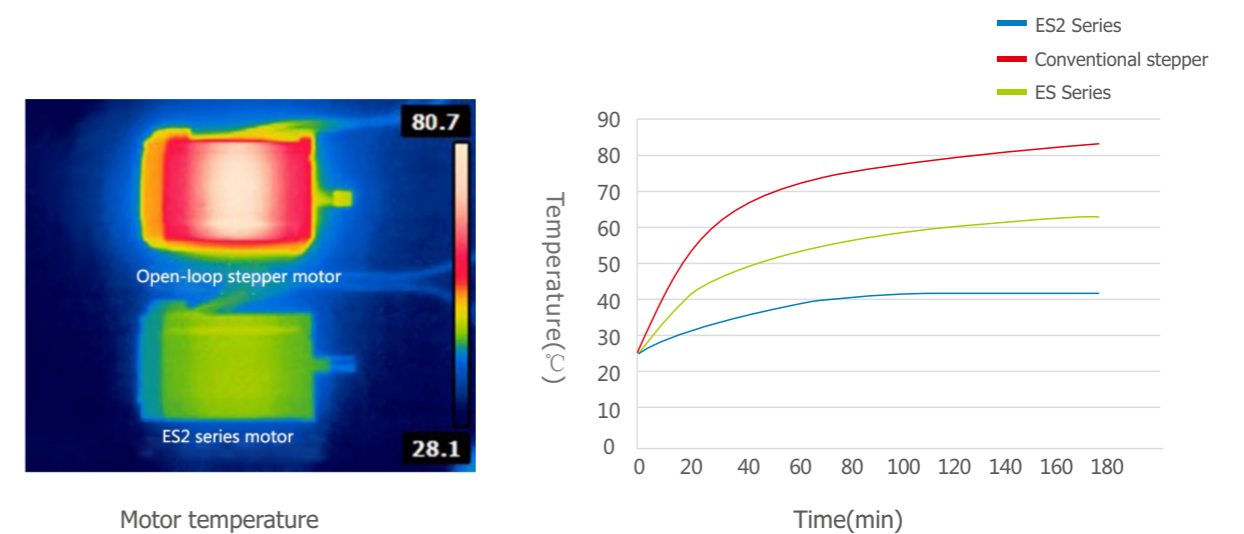

1.1 Features

1 Closed-loop for no loss of steps

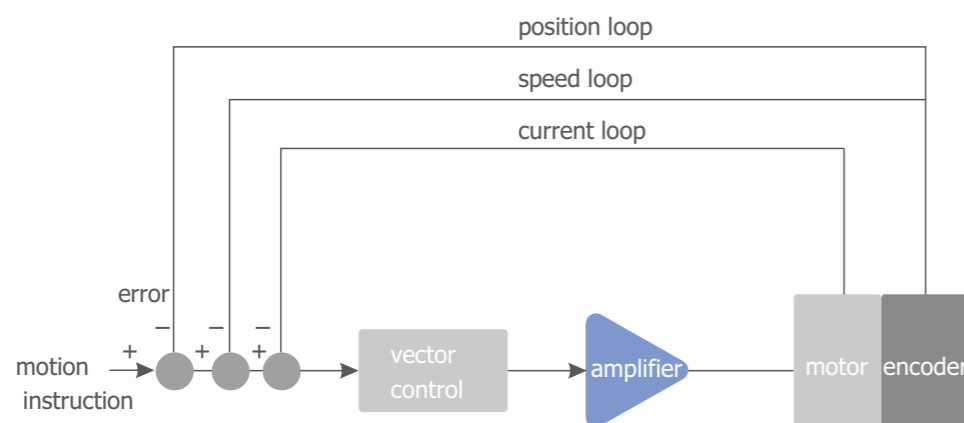

4 Smooth motion & Extra low motor noise for extending the life of the device

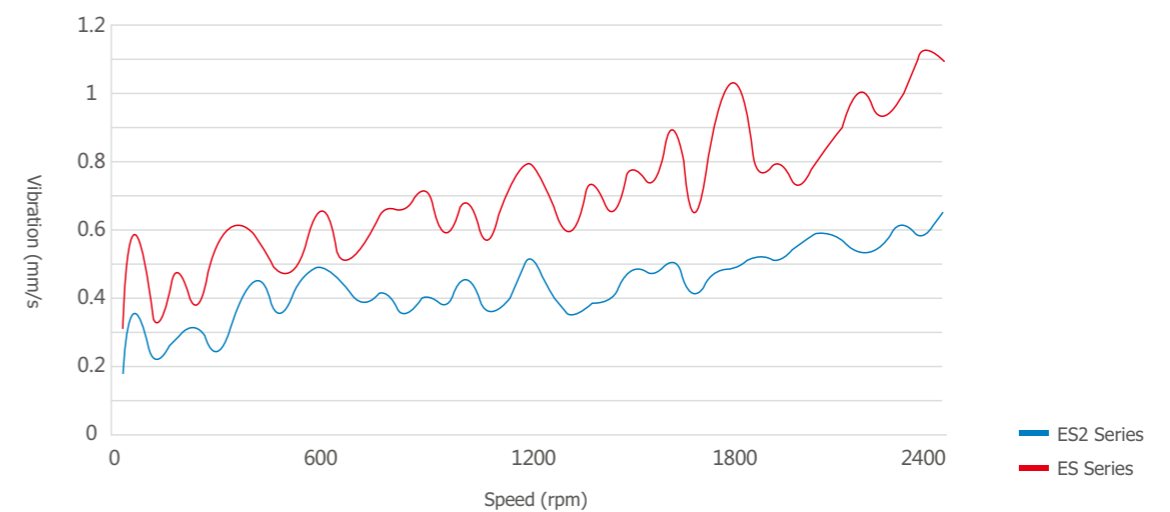

1.2 Typical Applications

Leadshine ES2 Easy Servo products have been widely used in various applications:



1.3 Typical System Configuration

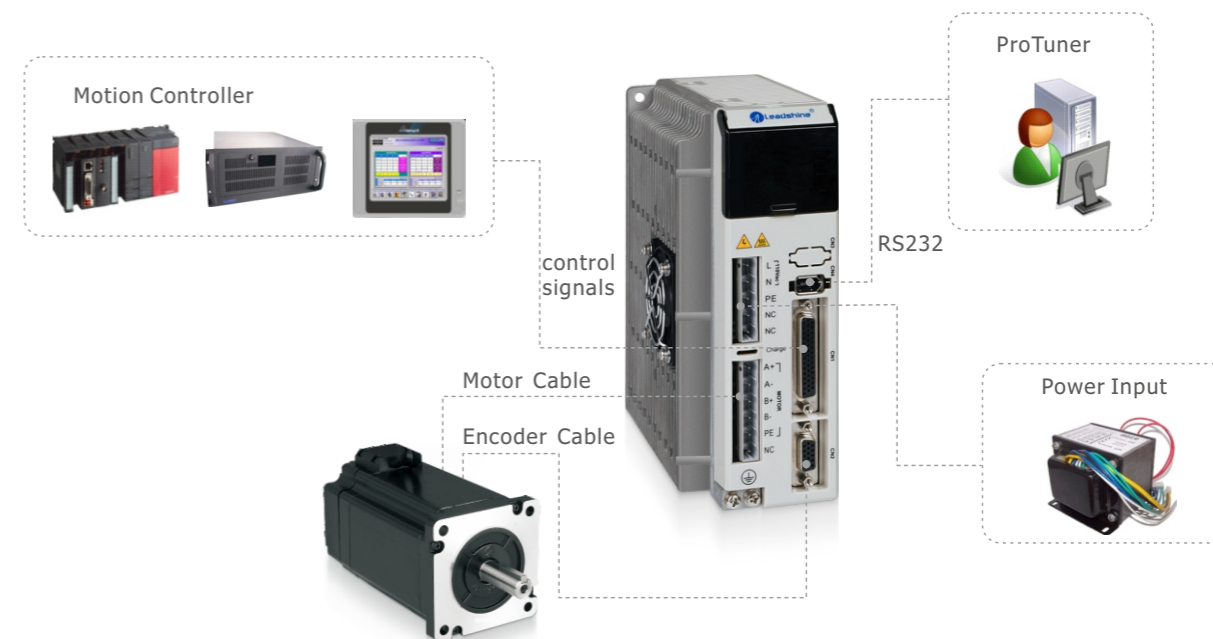

1.4 Matched Drives and Motors

Motor Size	ES2 Series Motors				Holding Torque (N·m)	Matching Drive	Motor Extension Cable	Encoder Extension Cable
	Standard Type	High Precision Type	Brake Type	Waterproof Type(IP67)				
NEMA8	ES2-M208003-E1	ES2-M208003-E2			0.03			
NEMA11	ES2-M211006-E1	ES2-M211006-E2	ES2-M21706B-E1		0.06			
NEMA17	ES2-M21706-E1	ES2-M21706-E2	ES2-M21708B-E1		0.6			
	ES2-M21708-E1	ES2-M21708-E2			0.8			
NEMA23	ES2-M22314-E1	ES2-M22314-E5	ES2-M22314B-E1	ES2-M22314WP-E1	1.4			
	ES2-M22323-E1	ES2-M22323-E5	ES2-M22323B-E1	ES2-M22323WP-E1	2.3			
NEMA24	ES2-M22422-E1	ES2-M22422-E5	ES2-M22422B-E1	-	2.2	ES2-D508		
	ES2-M22430-E1	ES2-M22430-E5	ES2-M22430B-E1	-	3.0			
2-phase NEMA34 Medium Voltage	ES2-M23445-E1	ES2-M23445-E5	ES2-M23445B-E1	ES2-M23445WP-E1	4.5		CABLEH-RZ Series	CABLEG-BM Series
	ES2-M23480-E1	ES2-M23480-E5	-	ES2-M23480WP-E1	8.0	ES2-DA808		
	ES2-M23485-E1	ES2-M23485-E5	ES2-M23485B-E1	ES2-M23485WP-E1	8.5			
2-phase NEMA34 High Voltage	ES2-MH23485-E1	ES2-MH23485-E5	ES2-MH23485B-E1	ES2-MH23485WP-E1	8.5	ES2-DA1208		
	ES2-MH234120-E1	ES2-MH234120-E5	ES2-MH234120B-E1	ES2-MH234120WP-E1	12			
3-phase NEMA34 High Voltage	ES2-MH33480-E1	ES2-MH33480-E5	ES2-MH33480B-E1	ES2-MH33480WP-E1	8.0			
	ES2-MH334100-E1	ES2-MH334100-E5	ES2-MH334100B-E1	ES2-MH334100WP-E1	10			
3-phase NEMA42 High Voltage	ES2-MH342120-E1	ES2-MH342120-E5	ES2-MH342120B-E1	-	12			
	ES2-MH342200-E1	ES2-MH342200-E5	-	-	20	ES2-3DA2306		

02 The Introduction of ES2 Series Easy Servo Drive

- Part Number
- Electrical Specifications
- Mechanical Specifications
- Connector Description



2.3 Mechanical Specifications

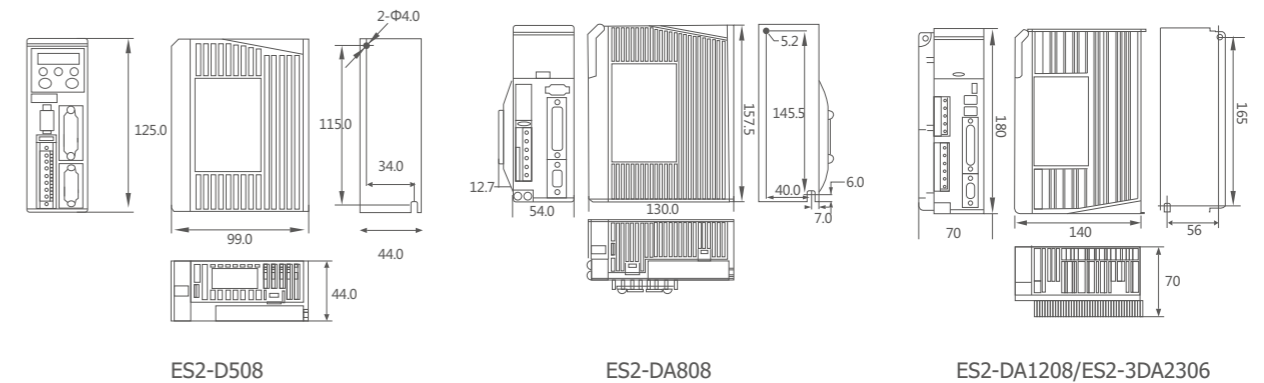

2.1 Part Number



- ① ES2: Vector series easy servo
- ② C: CANopen, E: EtherCAT, R: RS485, Blank: Step&Direction
- ③ 3: Matching 3-phase easy servo motor
Blank: Matching 2-phase easy servo motor
- ④ A: Single AC input power
Blank: DC input power
- ⑤ 808: 80V Max. input power, 8A peak current
- ⑥ Customization code

2.2 Electrical Specifications

ES2 Series Easy Servo				
Model				
Model	ES2-D508	ES2-DA808	ES2-DA1208	ES2-3DA2306
Operating Voltage	24-50Vdc	50-80Vac	70-110Vac	180-230Vac
Output Current	0.5-8A	0.5-8A		0.5-6A
Control Signal Voltage	5-24V			
Max. input Frequency	200KHZ			

2.4 Connector Description



Operable Panel:
Configure Parameter, Self Test,
Information Display



Operable Panel
CN3 Communication Connector(RS232)
CN1 Parallel I/O Connector
CN2 Encoder Signal Input
Power Supply Input Motor Connector

ES2-D508



Operable Panel
CN3 Communication Connector(RS232)
CN1 Parallel I/O Connector
CN2 Encoder Signal Input
Power Supply Input Motor Connector

ES2-DA808



Operable Panel
CN4 Communication Connector(RS232)
CN1 Parallel I/O Connector
CN2 Encoder Signal Input
Power Supply Input Motor Connector

ES2-DA1208/ES2-3DA2306

■ CN1: ES2-DA808, ES2-DA1208, ES2-3DA2306 Parallel I/O Connector

Part	Pin	Number	I/O	Connector Description
	1	NC		
	3	PUL+	I	Pulse signal (CCW in double pulse)
	4	PUL-	I	
	5	DIR+	I	Direction signal (CW in double pulse)
	6	DIR-	I	
	7	ALM+	O	Alarm signal
	8	ALM-	O	
	9	PEND+	O	In position signal
	10	PEND-	O	
	11	ENA+	I	Enable signal
	12	ENA-	I	
	15	CLR	I	
	23	EA+	O	Encoder A phase output
	24	EA-	O	
	25	EB+	O	Encoder B phase output
	26	EB-	O	
	27	Z+	O	Encoder Z signal output
	28	Z-	O	
	31	NC		
	34~44	NC		
外壳	FG			Ground terminal for shield

■ Cn1: ES2-D508 Parallel I/O Connector

Part	Pin	Name	I/O	Connector Description
	1	ENA+	I	Enable signal
	2	ENA-	I	
	3	PUL+	I	Pulse signal
	4	PUL-	I	
	5	DIR+	I	Direction signal
	6	DIR-	I	
	7~8	NC		
	9	SGND		Ground terminal for signal
	10	PEND+	O	In position signal

Part (Continued)	Pin	Name	I/O	Connector Description
	11	PEND-	O	In position signal
	12	ALM+	O	Alarm signal
	13	ALM-	O	
	14~16	NC		
	17	FG		Ground terminal for shield
	18	SGND		Ground terminal for signal
	19	+5V	O	+5V power output, MAX. 50mA
	20	EA+	O	Encoder A phase output
	21	EA-	O	
	22	EB+	O	Encoder B phase output
	23	EB-	O	
	24	Z+	O	Encoder Z signal output
	25	Z-	O	
26	SGND		Ground terminal for signal	

■ CN2: Encoder Signal Input

I/O	Part	Pin	Name	Connector description
	CN2	1	EA+	Encoder A+ input
		2	EB+	Encoder B+ input
		3	EGND	Ground terminal for encoder +5V output
		4	NC	
		5	NC	
		6	FG	Ground terminal for shield
		7	EZ+	Encoder Z+ signal input
		8	EZ-	Encoder Z- signal input
		9	NC	
		10	NC	
		11	EA-	Encoder A- phase input
		12	EB-	Encoder B- signal input
		13	VCC	+5V power input for encoder.
		14	NC	
		15	NC	

■ **CN3/CN4: ES2-D508, ES2-DA808, ES2-DA1208, ES2-3DA2306 Communication Connector (RS232)**

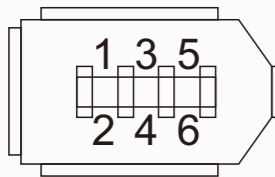
Part	Pin	Name	Connector Description
	1	GND	Ground
	2	TXD	RS232 transmit
	3	5V	Reserved +5V power output, Max. current 50mA
	4	RXD	RS232 receive
	5	RS485+	Reserved , RS485 +/A
	6	RS485-	Reserved , RS485 -/B

■ **Power Connector**

ES2-D508

Name	Connector Description
VDC	Power supply input: 24Vdc~50Vdc , Recommend 48Vdc
GND	
PE	Case ground
A+	Motor phase A
A-	
B+	Motor phase B
B-	

ES2-DA808

Name	Connector Description
AC	Power supply input: 50Vac~80Vac , Recommend75Vac
AC	
A+	Motor phase A
A-	
B+	Motor phase B
B-	

ES2-DA1208 Power Supply Connector

Name	Connector Description
L	Power supply input: 70Vac~120Vac , Recommend 110Vac
N	
PE	Case ground
NC	
NC	

ES2-DA1208 Motor Connector:

Name	Connector Description
A+	Motor phase A
A-	
B+	Motor phase B
B-	
PE	Case ground
NC	

ES2-3DA2306 Main Power Supply Connector

Name	Connector Description
L	Main power supply: 180Vac~230Vac , Recommend single 220Vac
N	
Br	External regeneration
P+	resistor connection

ES2-3DA2306 Motor & Control Power Supply Connector

Name	Connector Description
U	Motor phase U
V	
W	
PE	Case ground
L	Control Power Supply from 85VAC to 230VAC.
N	

Internal DC bus voltage output
The regeneration resistor should be connected between BR1 and

■ **ES2-D508 Typical Connections**

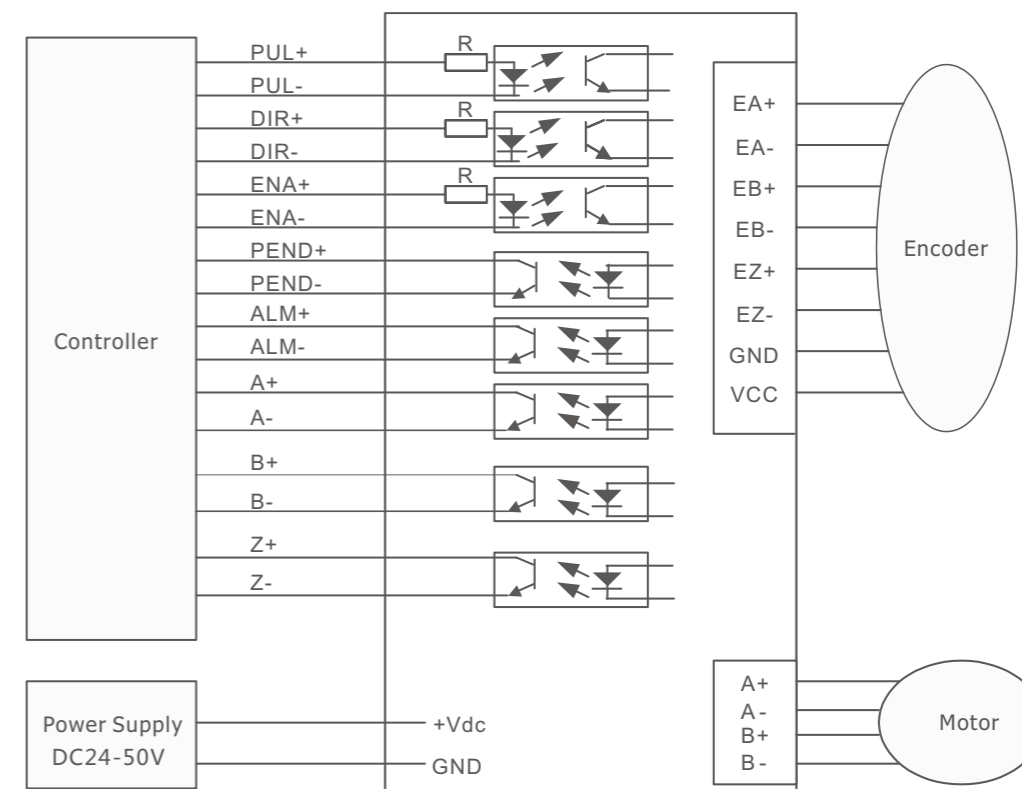

■ **ES2-DA808/ES2-DA1208 Typical Connections**

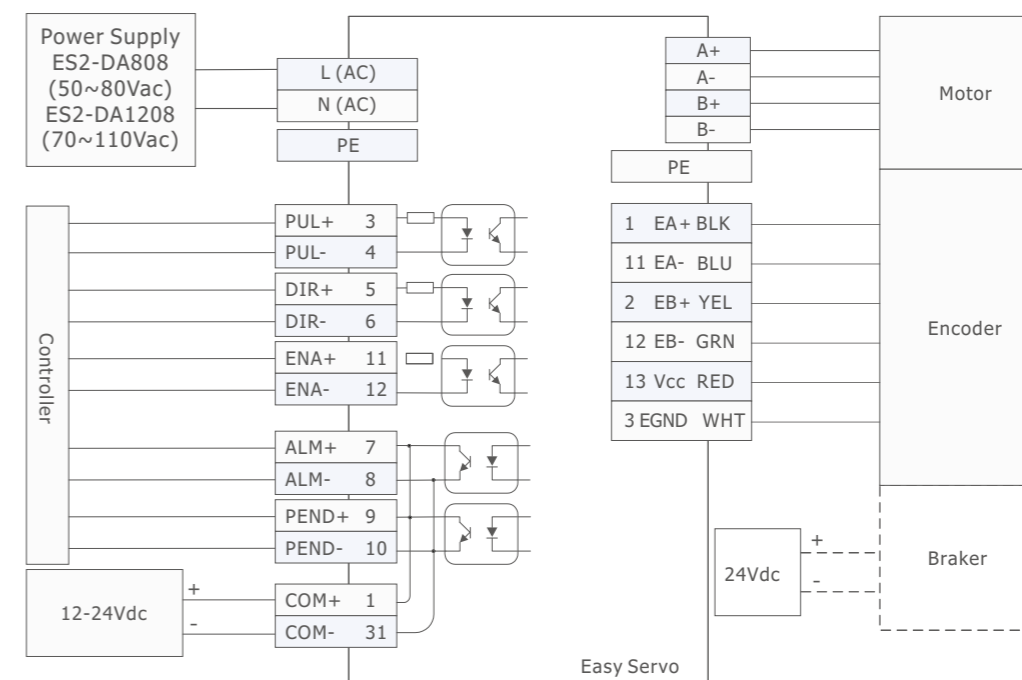

■ ES2-3DA2306 Typical Connections

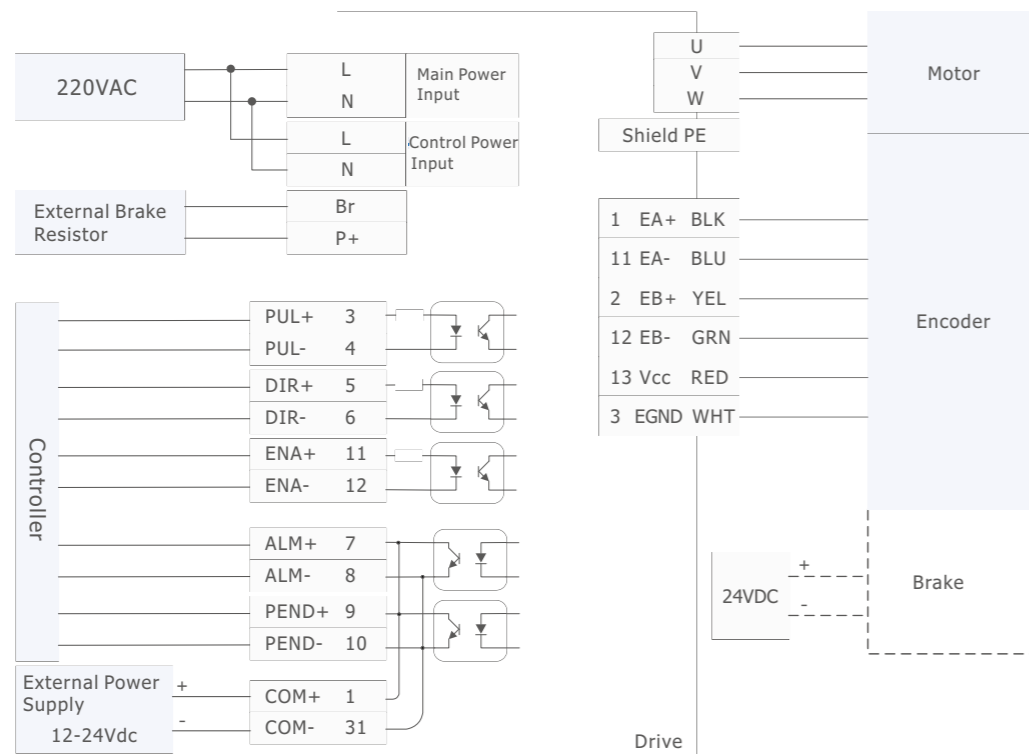

If motor with brake adopted, set parameter "PA0035" to "1" and use "Pend" as brake enable signal. Brake connection methods are shown below.

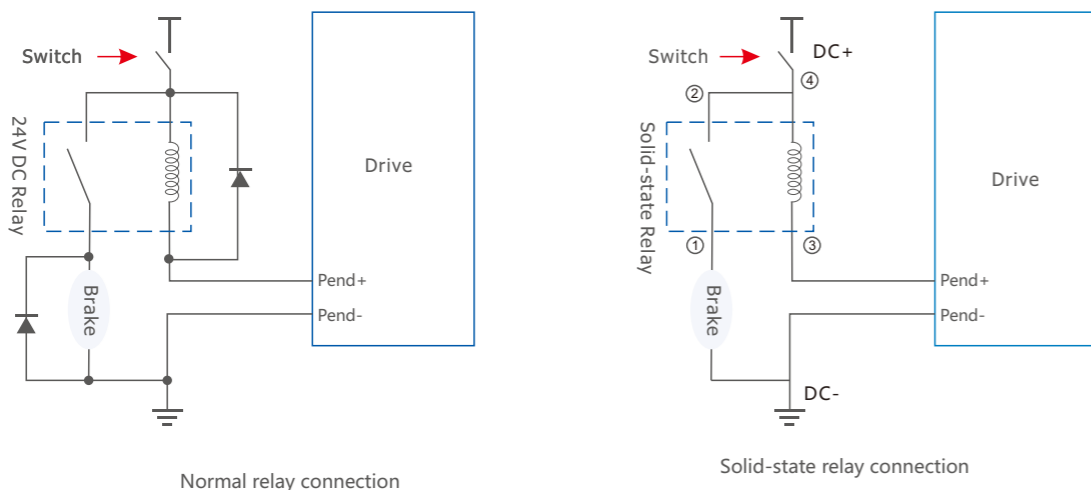

■ Operable Panel

Press key					
Description	Left Shift	Increase or previous	Decrease or Next	Mode Switching	Enter, Confirm

■ Operation Procedure

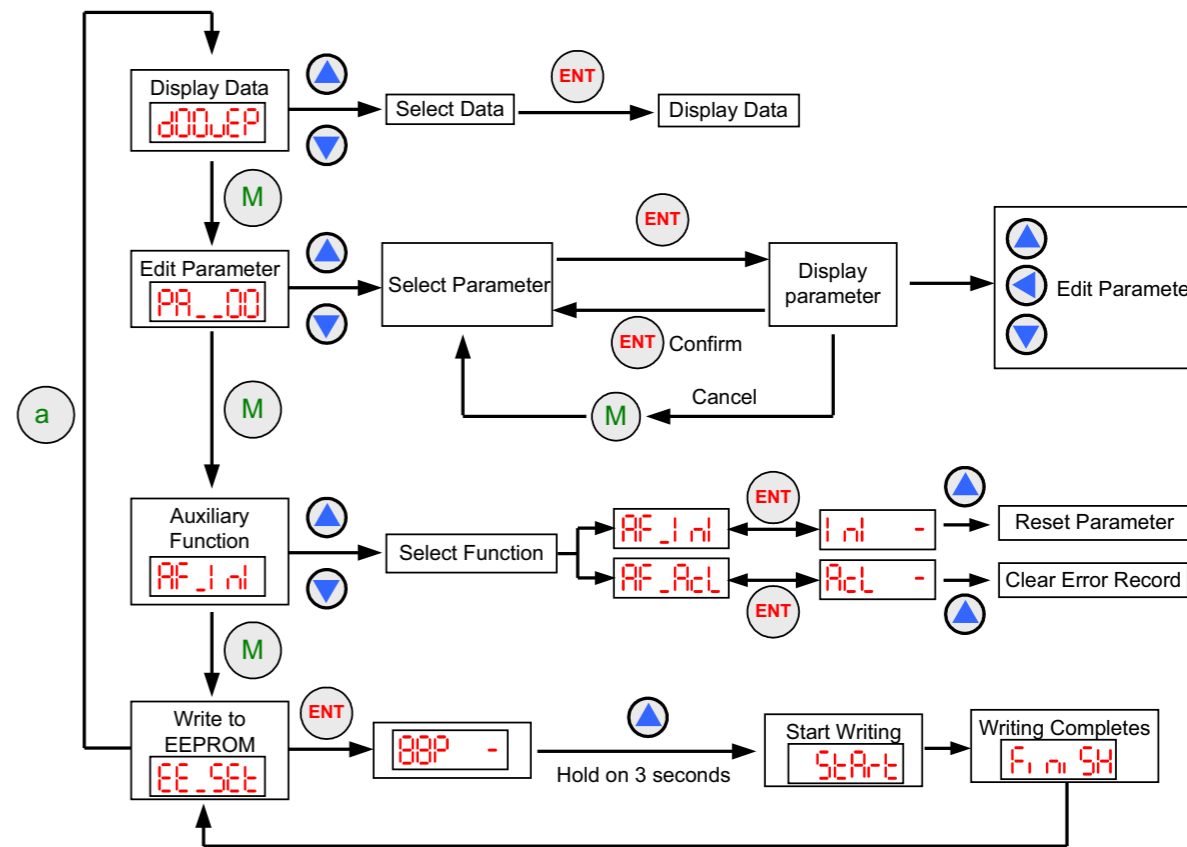

■ Display Data Mode

Display Code	Name	Description	
	L	Low order digits display	
	H	High order digits display	
	d00uEP	Position error between command and feedback	
	d01SPF	Actual feedback motor speed in RPM	
	d02SPr	Reference motor speed in RPM	
	d03PLF	Actual feedback position in pulses	
	d04PLr	Reference position in pulses	
	d05iP	Reference current (peak) in mA	
	d06Err	Error Code	
			Over-current protection activated
			Over-voltage protection activated
			Encoder cable error protection
		Position error exceeds the limit	
	d07 Pn	Bus voltage which is 1/10 of the actual value	
	d08 no	Drive version number	

03 The Introduction of ES2 Series Easy Servo Motor

- Part Number
- Motor Model & Electrical Specifications
- Mechanical Specifications
- Speed-Torque Curves



3.1 Part Number

ES2 MH 2 34 40 □ E1 - □

- ① ES2 series motor
- ② M: Motor
MH : High voltage motor
- ③ 2: 2-phase motor
3: 3-phase motor
- ④ Motor Size:
23: NEMA 23/ □57mm
34: NEMA 34/ □86mm
- ⑤ Holding Torque
40: 4.0 N.m
- ⑥ Blank: Standard
B: Motor with brake
WP: Waterproof
- ⑦ E1: 1000-lines encoder
E2: 2500-lines encoder
E5: 5000-lines encoder
- ⑧ Customization code

3.2 Motor Model&Electrical Specifications

Motor Size	Easy Servo Motor Models				Holding Torque (N·m)	Length Standard Type(mm)
	Standard Type	High Precision Type	Brake Type	Waterproof Type		
NEMA8	ES2-M208003-E1	ES2-M208003-E2			0.03	53
NEMA11	ES2-M211006-E1	ES2-M211006-E2			0.06	68
NEMA17	ES2-M21706-E1	ES2-M21706-E2	ES2-M21706B-E1		0.6	79
	ES2-M21708-E1	ES2-M21708-E2	ES2-M21708B-E1		0.8	95

Motor Size	Model				Holding Torque (N·m)	Length Standard Type (mm)
	Standard Type	High Precision Type	Brake Type	Waterproof Type		
2-phase NEMA23 Low voltage	ES2-M22314-E1	ES2-M22314-E5	ES2-M22314B-E1	ES2-M22314WP-E1	1.4	74
	ES2-M22323-E1	ES2-M22323-E5	ES2-M22323B-E1	ES2-M22323WP-E1	2.3	95
2-phase NEMA24 Low voltage	ES2-M22422-E1	ES2-M22422-E5	ES2-M22422B-E1	-	2.2	85
	ES2-M22430-E1	ES2-M22430-E5	ES2-M22430B-E1	-	3.0	103
2-phase NEMA34 Medium voltage	ES2-M23445-E1	ES2-M23445-E5	ES2-M23445B-E1	ES2-M23445WP-E1	4.5	108
	ES2-M23480-E1	ES2-M23480-E5	-	ES2-M23480WP-E1	8.0	126
	ES2-M23485-E1	ES2-M23485-E5	ES2-M23485B-E1	ES2-M23485WP-E1	8.5	146
2-phase NEMA34 High voltage	ES2-MH23485-E1	ES2-MH23485-E5	ES2-MH23485B-E1	ES2-MH23485WP-E1	8.5	146
	ES2-MH234120-E1	ES2-MH234120-E5	ES2-MH234120B-E1	ES2-MH234120WP-E1	12	157
3-phase NEMA34 High voltage	ES2-MH33480-E1	ES2-MH33480-E5	ES2-MH33480B-E1	ES2-MH33480WP-E1	8.0	157
	ES2-MH334100-E1	ES2-MH334100-E5	ES2-MH334100B-E1	ES2-MH334100WP-E1	10	184
3-phase NEMA42 High voltage	ES2-MH342120-E1	ES2-MH342120-E5	ES2-MH342120B-E1	-	12	162
	ES2-MH342200-E1	ES2-MH342200-E5	-	-	20	244

3.3 Mechanical Specifications(Unit: mm 1 inch=25.4mm)

Model	Length L (mm)	Holding Torque (N·m)	Current/Phase (A)	Rotational inertia (Kg·cm ²)	Weight (Kg)
ES2-M208003-E1/E2	53	0.03	1.3	0.0045	0.082

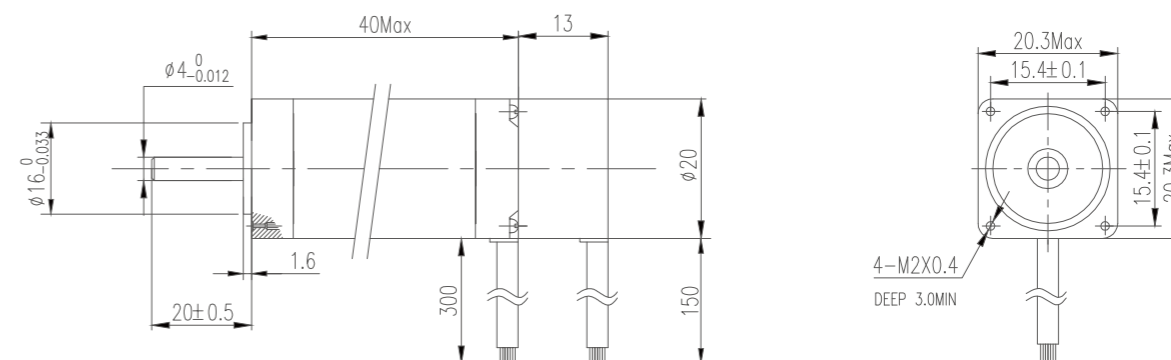

Model	Length L (mm)	Holding Torque (N·m)	Current/Phase (A)	Rotational Inertia (Kg·cm ²)	Weight (Kg)
ES2-M211006-E1/E2	68	0.06	1.3	0.013	0.18

Model	Length L (mm)	Holding Torque (N·m)	Current/Phase (A)	Rotational Inertia (Kg·cm ²)	Weight (Kg)
ES2-M22314-E1/E5	74	1.4	4.0	0.28	0.9
ES2-M22323-E1/E5	95	2.3	5.0	0.48	1.2

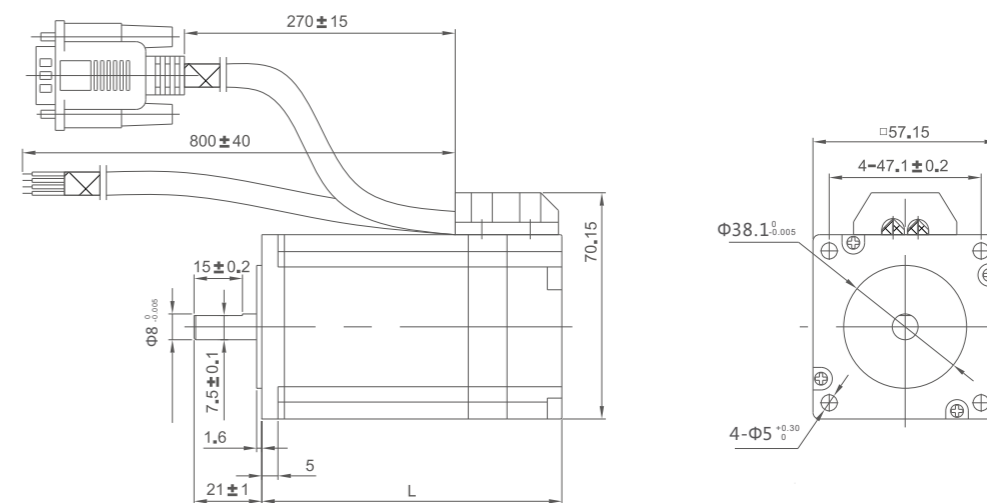
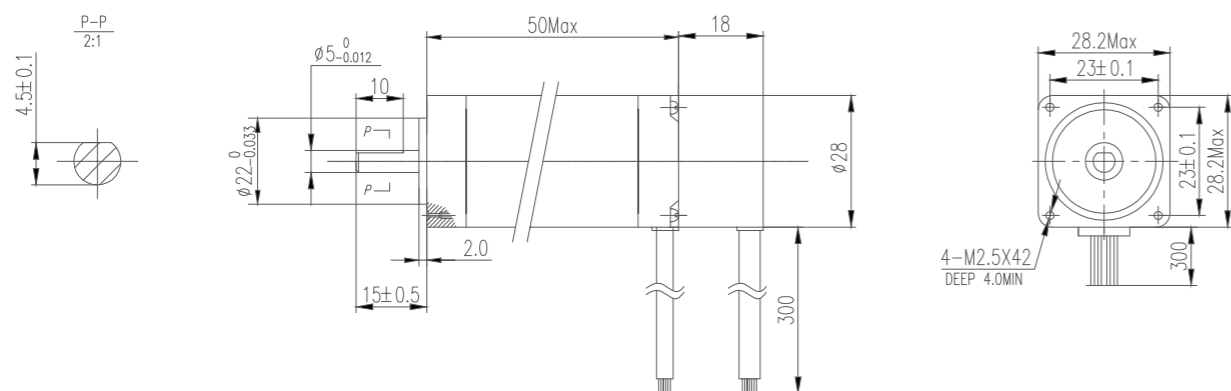

Model	Length L (mm)	Holding Torque (N·m)	Current/Phase (A)	Rotational Inertia (Kg·cm ²)	Weight (Kg)
ES2-M21706-E1/E2	79	0.6	2.3	0.077	0.53
ES2-M21708-E1/E2	95	0.8	2.3	0.115	0.67

Model	Length L (mm)	Holding Torque (N·m)	Current/Phase (A)	Rotational Inertia (Kg·cm ²)	Weight (Kg)
ES2-M22422-E1/E5	85	2.2	5.0	0.49	1.2
ES2-M22430-E1/E5	103	3.0	5.0	0.69	1.5

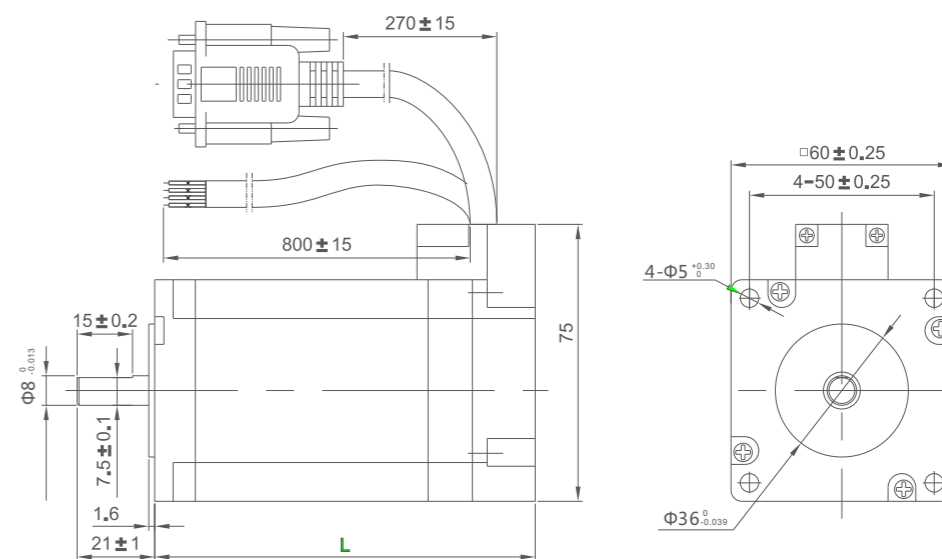
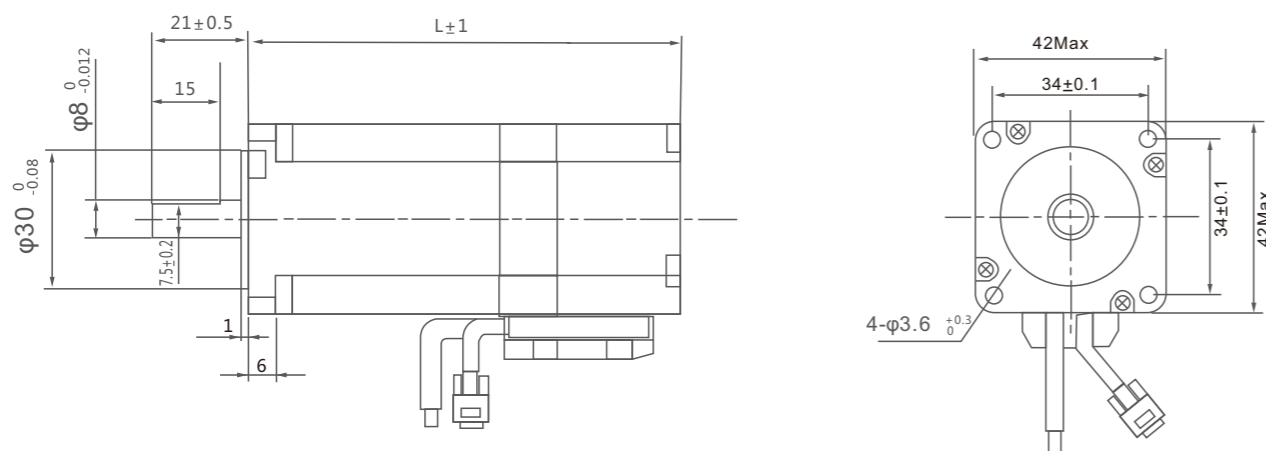

Model	Length L (mm)	Holding Torque (N·m)	Current/Phase (A)	Rotational Inertia (Kg·cm ²)	Weight (Kg)
ES2-M23445-E1/E5	108	4.5	6.0	1.95	2.7
ES2-M23480-E1/E5	126	8.0	6.0	2.5	3.5
ES2-M23485-E1/E5	146	8.5	6.0	2.8	4.0

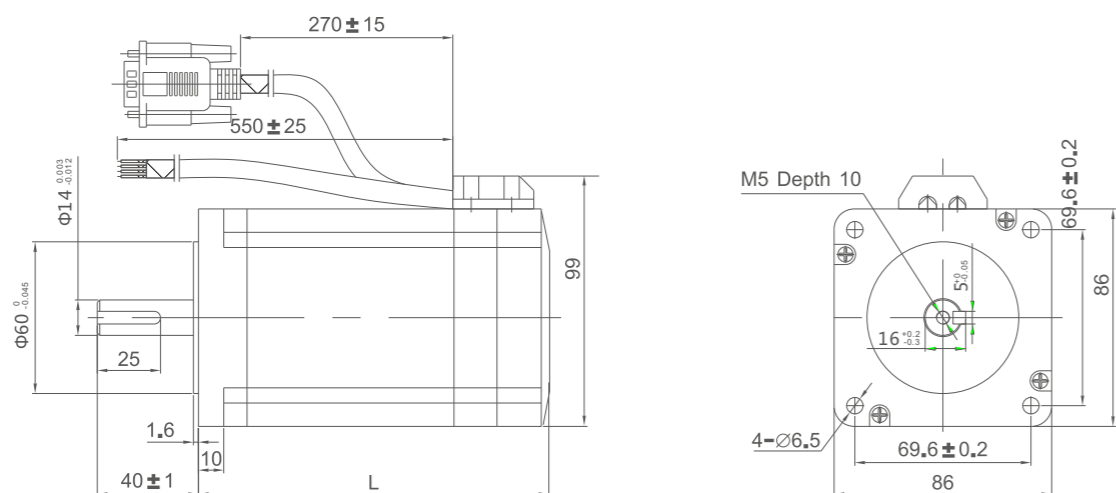

Model	Length L (mm)	Holding Torque (N·m)	Current/Phase (A)	Rotational Inertia (Kg·cm ²)	Weight (Kg)
ES2-MH33480-E1/E5	157	8.0	4.5	3	4.7
ES2-MH334100-E1/E5	184	10.0	3	4	5.6

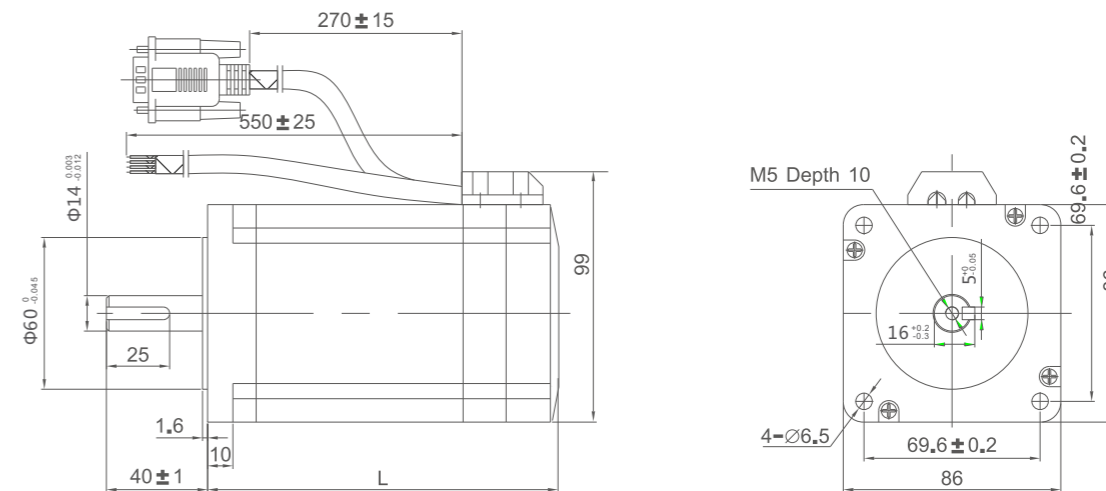

Model	Length L (mm)	Holding Torque (N·m)	Current/Phase (A)	Rotational Inertia (Kg·cm ²)	Weight (Kg)
ES2-MH23485-E1/E5	146	8.5	6.0	2.8	4
ES2-MH234120-E1/E5	157	12	6.0	3	4.7

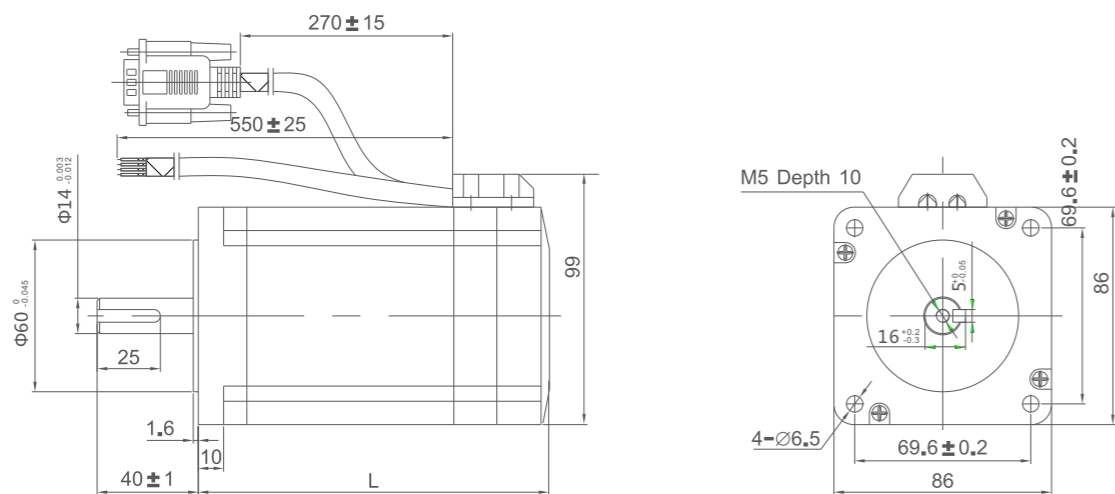

Model	Length L (mm)	Holding Torque (N·m)	Current/Phase (A)	Rotational Inertia (Kg·cm ²)	Weight (Kg)
ES2-MH242120-E1/E5	162	12.0	4.2	10.8	8.6
ES2-MH42200-E1/E5	244	20.0	5.2	17	12.8

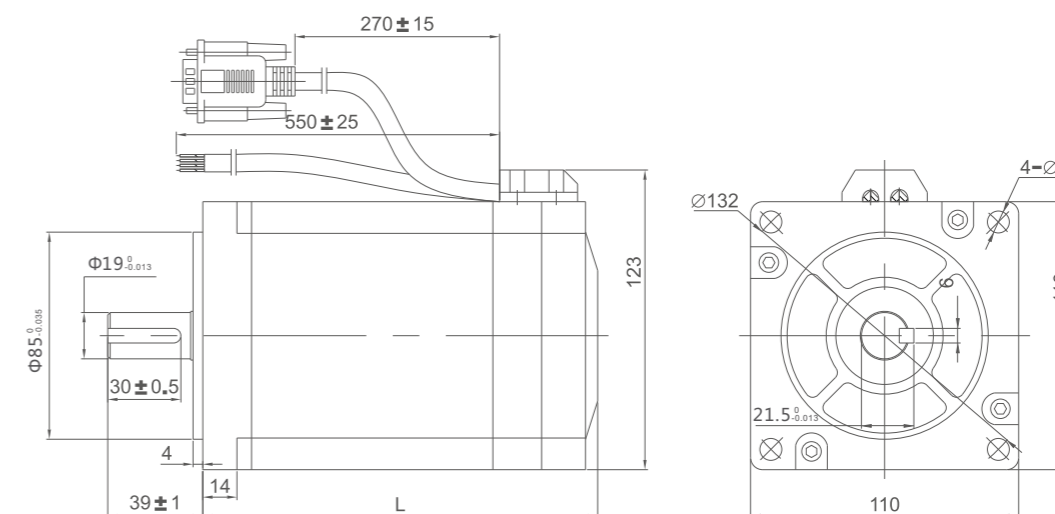

Model	Length L (mm)	Holding Torque (N·m)	Current/Phase (A)	Rotational Inertia (Kg·cm ²)	Weight (Kg)
ES2-M21706B-E1/E2	115	0.5	2.3	0.077	0.78
ES2-M21708B-E1/E2	131	0.7	2.3	0.115	0.92

Model	Length L (mm)	Holding Torque (N·m)	Current/Phase (A)	Rotational Inertia (Kg·cm ²)	Weight (Kg)
ES2-M23445B-E1/E5	142	4.5	6.0	1.95	3.2
ES2-M23485B-E1/E5	180	8.5	6.0	2.8	4.5

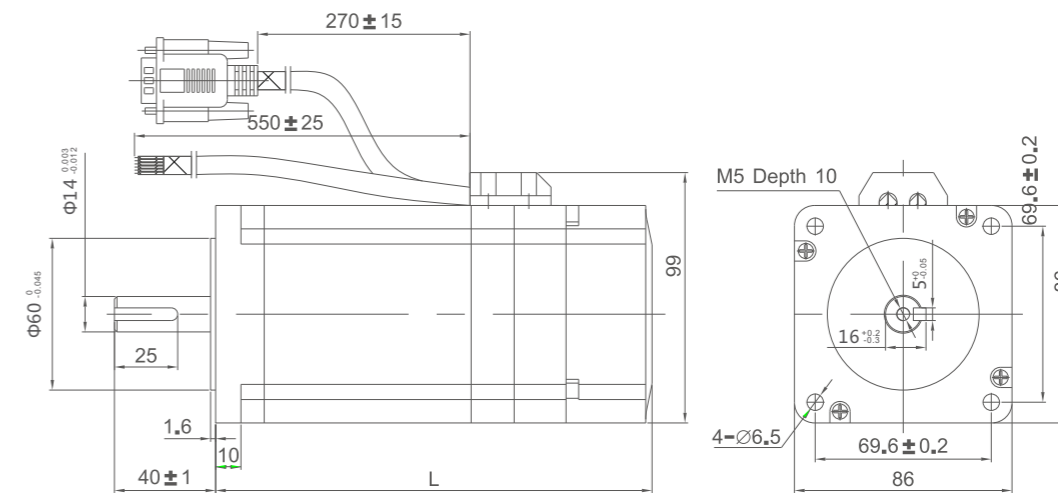
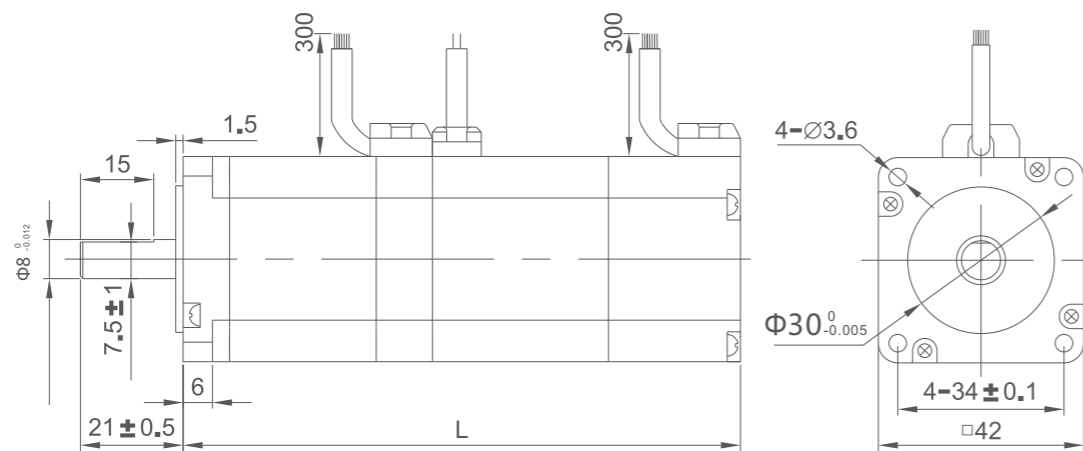

Model	Length L (mm)	Holding Torque (N·m)	Current/Phase (A)	Rotational Inertia (Kg·cm ²)	Weight (Kg)
ES2-M22314B-E1/E5	114	1.4	4.0	0.28	1.25
ES2-M22323B-E1/E5	134	2.3	5.0	0.48	1.55

Model	Length L (mm)	Holding Torque (N·m)	Current/Phase (A)	Rotational Inertia (Kg·cm ²)	Weight (Kg)
ES2-MH23485B-E1/E5	180	8.5	6.0	2.8	4.5
ES2-MH234120B-E1/E5	190	12	6.0	3	5.2

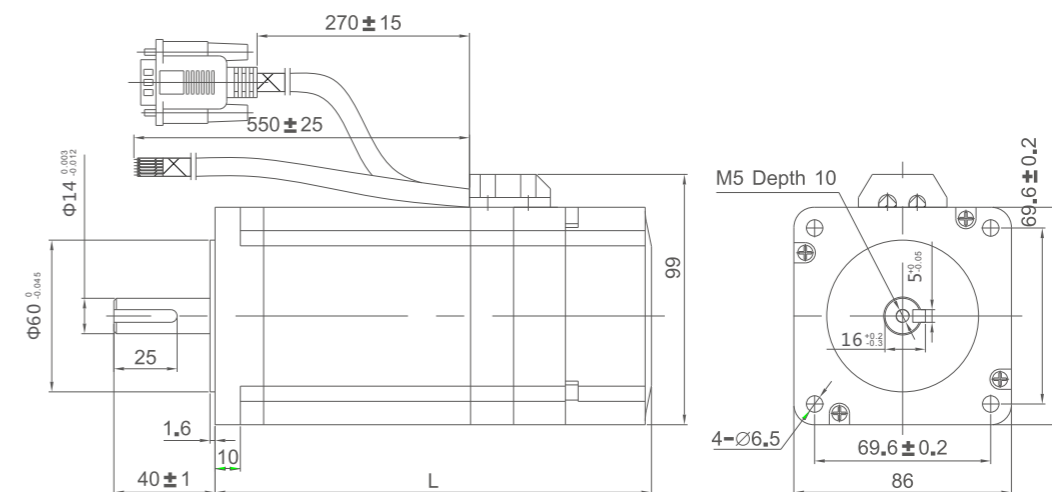
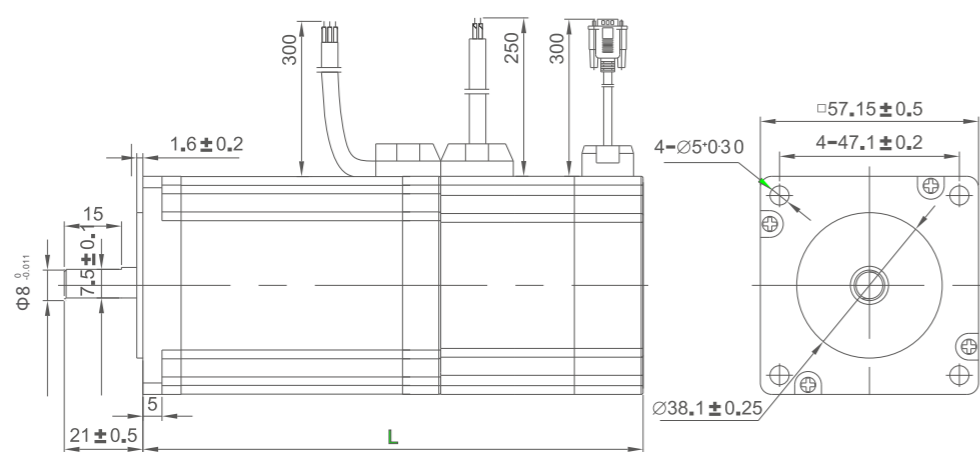

Model	Length L (mm)	Holding Torque (N·m)	Current/Phase (A)	Rotational Inertia (Kg·cm ²)	Weight (Kg)
ES2-MH33480B-E1/E5	190	8.0	4.5	3.5	5
ES2-MH334100B-E1/E5	218	10.0	3	4	6.1

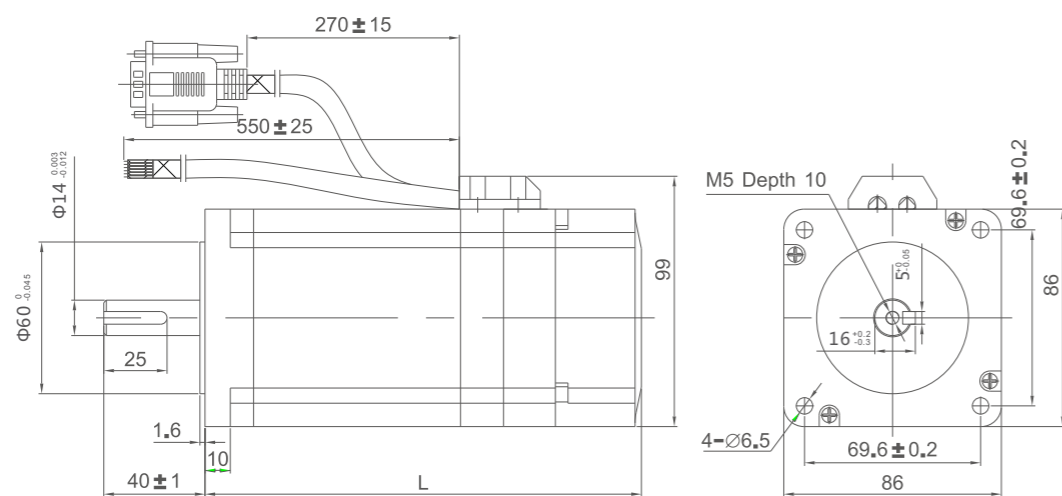

Model	Length L (mm)	Holding Torque (N·m)	Current/Phase (A)	Rotational Inertia (Kg·cm ²)	Weight (Kg)
ES2-MH342120B-E1/E5	207	12.0	4.2	10.8	9.2

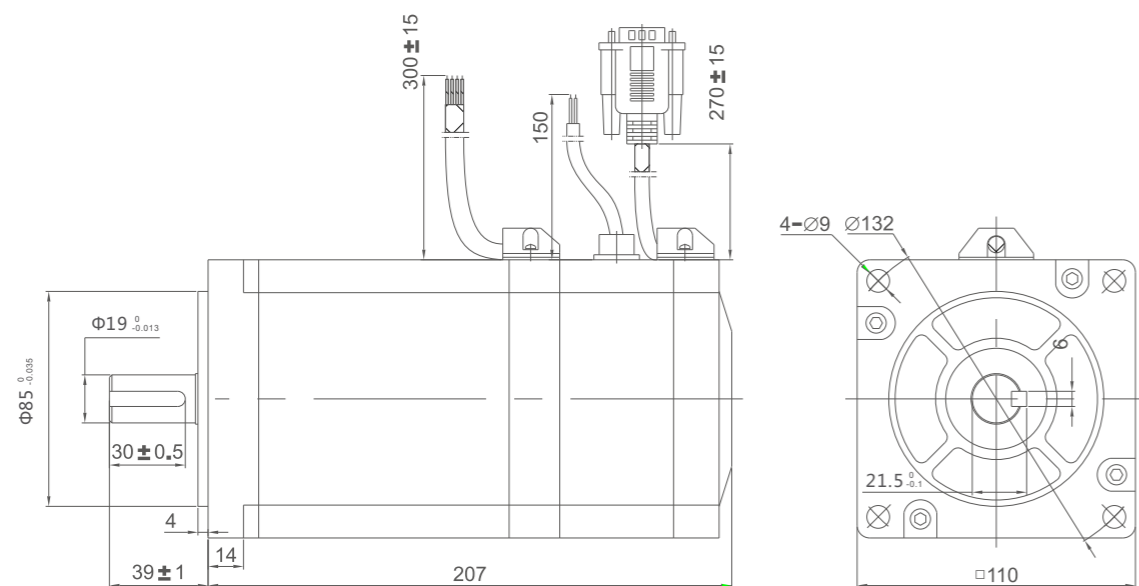

Waterproof Type

Model	Length L (mm)	Holding Torque (N·m)	Current/Phase (A)	Rotational Inertia (Kg·cm ²)	Weight (Kg)
ES2-M22314WP-E1/E5	94	1.4	4.0	0.28	1.05
ES2-M22323WP-E1/E5	115	2.3	5.0	0.48	1.35

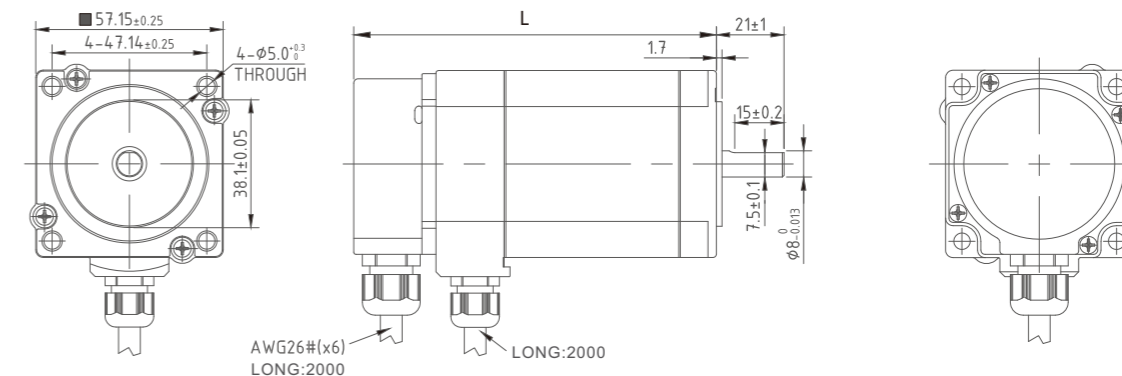

Model	Length L (mm)	Holding Torque (N·m)	Current/Phase (A)	Rotational Inertia (Kg·cm ²)	Weight (Kg)
ES2-M23445WP-E1/E5	115	4.5	6.0	1.95	2.95
ES2-M23480WP-E1/E5	133	8.0	6.0	2.5	3.75
ES2-M23485WP-E1/E5	153	8.5	6.0	2.8	4.25
ES2-MH23485WP-E1/E5	153	8.5	6.0	2.8	4.25
ES2-MH234120WP-E1/E5	164	12	6.0	3	4.95
ES2-MH33480WP-E1/E5	162	8.0	4.5	3.5	4.75
ES2-MH334100WP-E1/E5	191	10.0	3	4	5.85

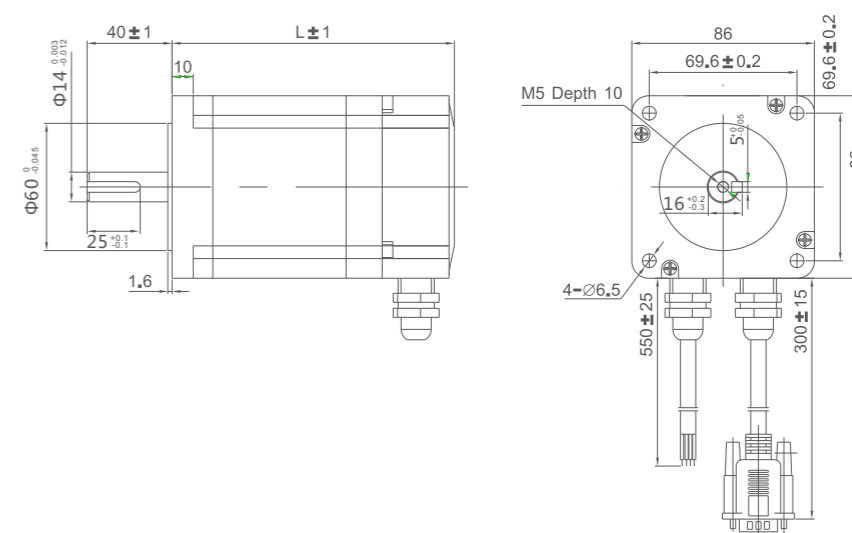

3.4 Speed-Torque Curves

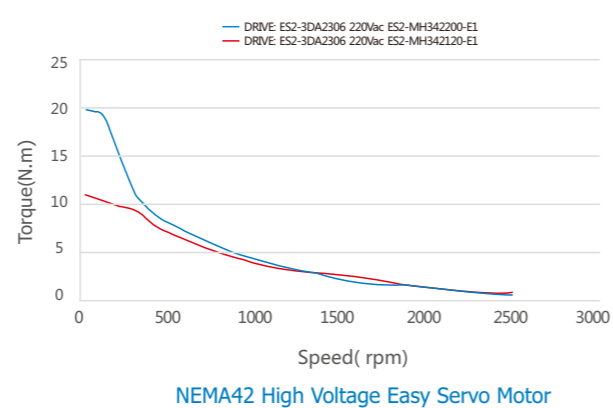
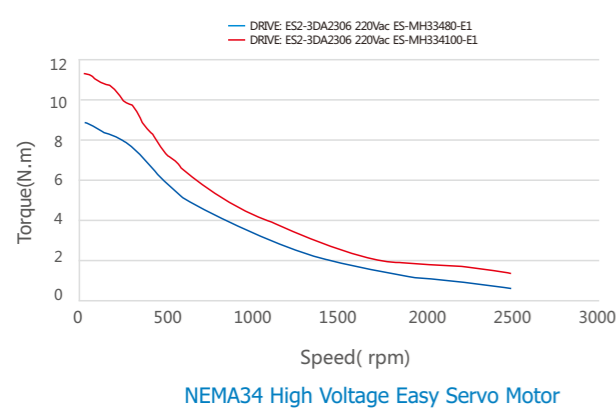
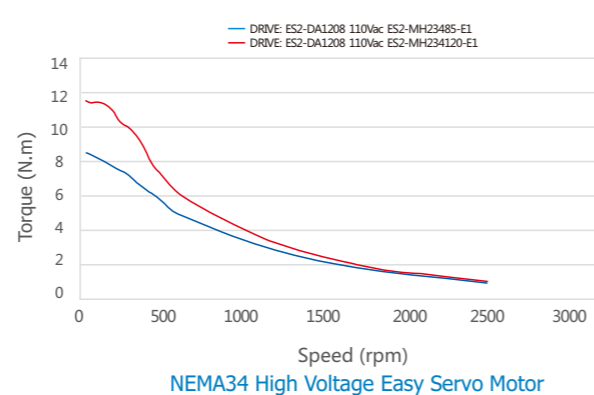
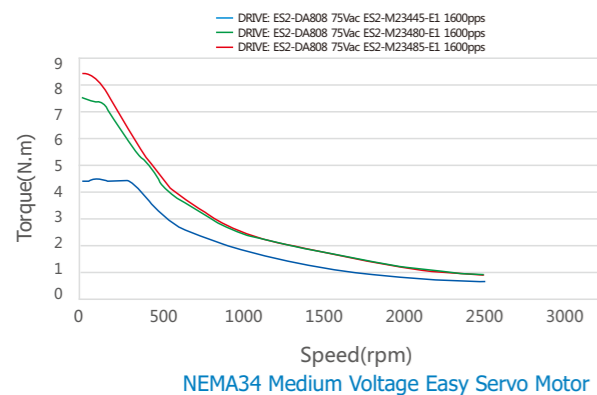
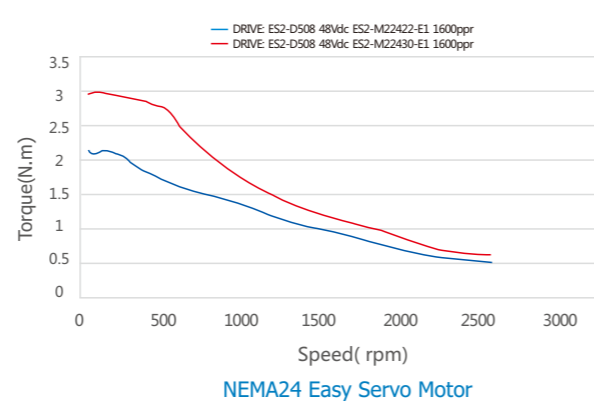
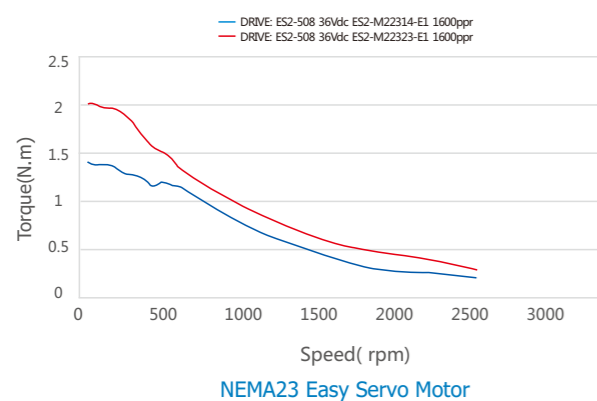
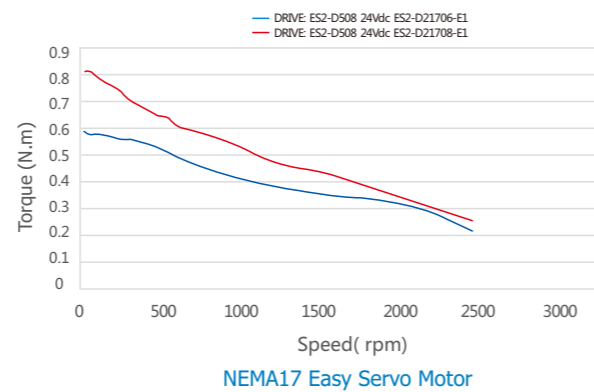
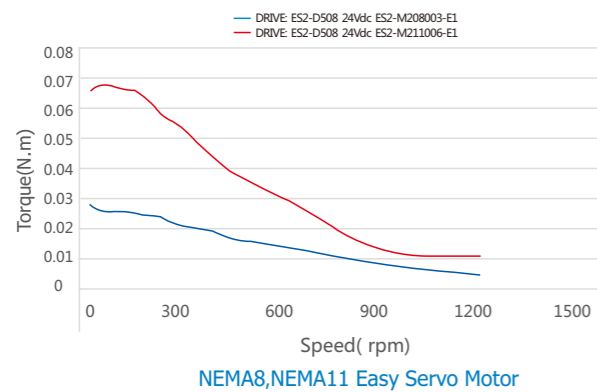

04 ES2 Series Accessories

- Motor & Encoder Extension Cable
- Tuning Cable & Control Signal Connector
- Power Supplies



4.1 Motor & Encoder Extension Cable

Number	Picture	Name	Discription
1		Motor Cable: CABLEH-RZ3M0 CABLEH-RZ5M0 CABLEH-RZ10M0	Length 3m(standard), 5m and 10m optional For all easy servo drivers and motors.
2		Motor Cable: CABLEG-BM3M0 CABLEG-BM5M0 CABLEG-BM10M0	Length 3m(standard), 5m and 10m optional For the ES2-D508, Es2- Da808, ES2-DA1208, ES2-3DA2306

■ CABLEG-BM (ES2-D508, ES2-DA808, ES2-DA1208, ES2-3DA2306)

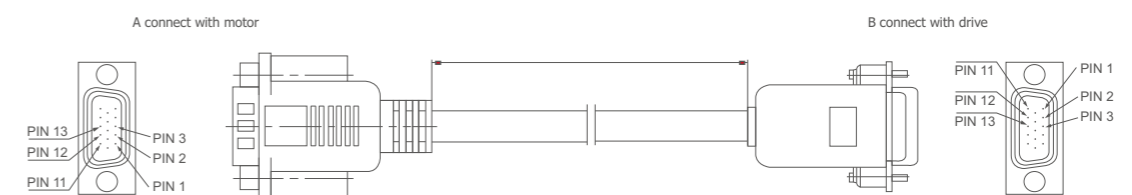

A:HDB15 Female	1	2	3	7	8	11	12	13
Colour	BLK	RED	WHT			YEL	GRN	BLU
Name	EA+	VCC	GND	Z+	Z-	EB+	EB-	EA-
B:HDB15 Female	1	13	3	7	8	2	12	11

4.2 Control Signal Connector

■ ES2-DA808, ES2-DA1208, ES2-3DA2306 CN1 Parallel I/O

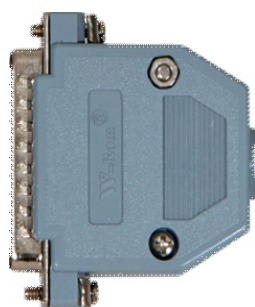

Pin	Name	Description
3	PUL +	Pulse signal positive input
4	PUL -	Pulse signal negative input
5	DIR +	Direction signal positive input
6	DIR -	Direction signal negative input
11	ENA+	Enable signal positive input
12	ENA-	Enable signal negative input
7	ALM +	Alarm signal output
8	ALM -	
9	PEND+	In position output
10	PEND+	
23	EA+	Encoder signal A+ output
24	EA-	Encoder signal A- output
25	EB+	Encoder signal B+ output
26	EB-	Encoder signal B- output
27	Z+	Z signal positive output
28	Z-	Z signal negative output

■ ES2-D508 CN1 Parallel I/O

Pin	Name	Description
3	PUL +	Pulse signal positive input
4	PUL -	Pulse signal negative input
5	DIR +	Direction signal positive input
6	DIR -	Direction signal negative input
11	ENA+	Enable signal positive input
12	ENA-	Enable signal negative input
7	ALM +	Alarm signal output
8	ALM -	
9	PEND+	In position output
10	PEND+	
20	EA+	Encoder signal A+ output
21	EA-	Encoder signal A- output
22	EB+	Encoder signal B+ output
23	EB-	Encoder signal B- output
24	Z+	Z signal positive output
25	Z-	Z signal negative output

■ Communication Cable (RS232)



■ Length 1.5m	■ For connecting with ProTuner
Note: Please connect with a Rs232 to USB converter if the PC without Rs232 serial port	

4.3 Power Supplies

1 SPS Series

■ Features

- Compact size and light in weight
- Input Voltage: 220VAC±10% or 110VAC±10%
- Short cut protection, over-current protection, over-voltage protection and I
- High power and high efficiency
- Easy to use



■ Electrical Specifications

Model	Output Voltage(Vdc)	Output RMS Current (A)	Input Voltage(Vac)	Dimension(mm)	Weight(kg)
SPS2410	24	10	220±10%	119*110*50	0.8
SPS369	36	9	220±10%	214.5*113.6*49.5	0.9
SPS487	48	8	220±10%	214.5*113.6*49.5	0.9

■ Mechanical Specifications(Unit: mm 1 inch=25.4mm)

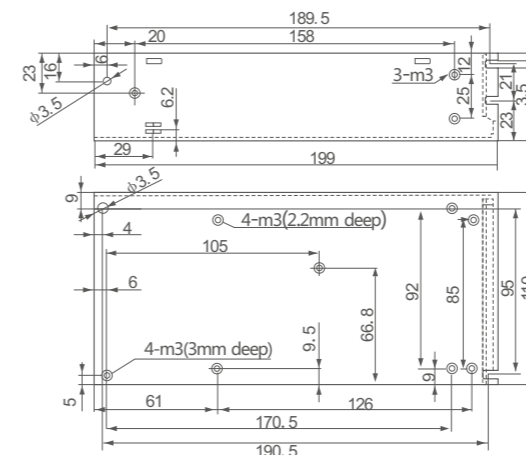

SPS2410

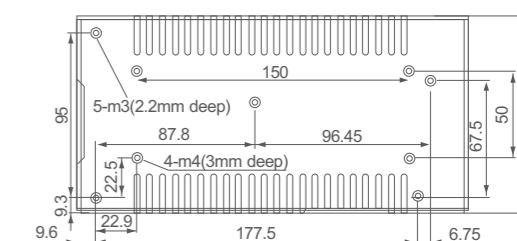





SPS369, SPS488

05 ES2 Series Order Information



	ES2-3DA2306	ES2-DA1208	ES2-DA808	ES2-D508
Drives				
Motors	ES2-MH342200-E1	ES2-MH234120-E1	ES2-M23485-E1	ES2-M22430-E1
	ES2-MH342120-E1	ES2-MH23485-E1	ES2-M23480-E1	ES2-M22422-E1
	ES2-MH334100-E1		ES2-M23445-E1	ES2-M22323-E1
	ES2-MH33480-E1			ES2-M22314-E1
				ES2-M21708-E1
				ES2-M21706-E1
				ES2-M211006-E1
Accessories	CABLEH-RZ Motor Cable & CABLEG-BM Encoder Cable			
	Control Signal Connector HDB-44P / HDB-26P			
	RS232 Cable for ProTuner CABLE-ACH1000			

	ES2-3DA2306	ES2-DA1208	ES2-DA808	ES2-D508
Drives				
Waterproof Motors	ES2-MH334100WP-E1	ES2-MH234120WP-E1	ES2-M23485WP-E1	ES2-M22323WP-E1
	ES2-MH33480WP-E1	ES2-MH23485WP-E1	ES2-M23480WP-E1	ES2-M22314WP-E1
			ES2-M23445WP-E1	
Accessories	CABLEH-RZ Motor Cable & CABLEG-BM Encoder Cable			
	Control Signal Connector HDB-44P / HDB-26P			
	RS232 Cable for ProTuner CABLE-ACH1000			

	ES2-3DA2306	ES2-DA1208	ES2-DA808	ES2-D508
Drives				
High Precision Motors	ES2-MH342200-E5	ES2-MH234120-E5	ES2-M23485-E5	ES2-M22430-E5
	ES2-MH342120-E5	ES2-MH23485-E5	ES2-M23480-E5	ES2-M22422-E5
	ES2-MH334100-E5		ES2-M23445-E5	ES2-M22323-E5
	ES2-MH33480-E5			ES2-M22314-E5
				ES2-M21708-E2
Accessories	CABLEH-RZ Motor Cable & CABLEG-BM Encoder Cable			
	Control Signal Connector HDB-44P / HDB-26P			
	RS232 Cable for ProTuner CABLE-ACH1000			
	ES2-M21706-E2			
			ES2-M211006-E2	
			ES2-M208003-E2	

	ES2-3DA2306	ES2-DA1208	ES2-DA808	ES2-D508
Drives				
Motors with Brake	ES2-MH342120B-E1	ES2-MH234120B-E1	ES2-M23485B-E1	ES2-M22323B-E1
	ES2-MH342100B-E1	ES2-MH23485B-E1	ES2-M23480B-E1	ES2-M22314B-E1
	ES2-MH33480B-E1		ES2-M23445B-E1	ES2-M21708B-E1
Accessories	CABLEH-RZ Motor Cable & CABLEG-BM Encoder Cable			
	Control Signal Connector HDB-44P / HDB-26P			
	RS232 Cable for ProTuner CABLE-ACH1000			
			ES2-M21706B-E1	